

## **EXHIBIT "A"**

### **RESTRICTIONS**

GRANTORS hereby restrict the Property as follows for the purpose of protecting the value and desirability of surrounding properties, and shall be binding on all parties having any right, title, or interest in or to the Property or any part thereof, and their heirs, successors, and assigns:

FIRST: The Property or any tracts subdivided therefrom, shall be used for residential purposes only, and no building shall be erected, altered, placed, or permitted to remain on any tracts subdivided therefrom other than one detached single family dwelling not to exceed two stories in height, a private garage for not less than two automobiles, and three outbuildings to be used for storage, home shop or barn provided such outbuilding is located behind the back of the residence and not used for commercial purposes as set forth in paragraph FIFTH.

SECOND: Any single story residence constructed on the Property, or any tracts subdivided therefrom, must have a ground floor area of not less than one thousand seven hundred fifty square feet (1750 sq. ft) exclusive of open or screen porches, terraces, patios, driveways, carports, and garages. Any residence other than a single story residence must have not less than one thousand two hundred fifty square feet (1250 sq. ft.) of ground floor living area, exclusive of open or screen porches, terraces, patios, driveways, carports, and garages. The exterior walls of any residence shall consist of not less than 30% brick or stone construction on wall facing Rifle Range Road.

THIRD: No building shall be located on the Property, or any tracts subdivided therefrom, nearer to the front property line than 100 feet or nearer to the side property line than 10 feet.

FOURTH: No noxious or offensive activity shall be carried on upon the Property, or any tracts subdivided therefrom, nor shall anything be done thereon which may be or may become an annoyance or nuisance to the surrounding property owners, including, but not limited to loud noises, offensive smells and/or annoying activities, including, but not limited to use of four wheelers and/or motorcycles for racing.

FIFTH: No structure of a temporary character, trailer, prefabricated home, mobile home, manufactured home, tent, shack, garage, or other out building shall be used on the Property, or any tracts subdivided therefrom, at any time as a residence, office or workshop, either temporarily or permanently, except during construction, an R.V. may be used up to six (6) months.

SIXTH: Any garage or other building constructed on the Property shall conform to good architectural and workmanship practices.

SEVENTH: No signs of any character shall be allowed on the Property, or any tracts subdivided therefrom, except one sign of not more than five square feet advertising the property for sale or rent; provided, however, that declarant and any other person or entity engaged in the

construction and sale of residences within the subdivision shall have the right, during the construction and sales period to construct and maintain such facilities as may be reasonably necessary or convenient for such construction and sale, including, but not limited to, signs, offices, storage areas, and model units.

EIGHTH: The Property or any tracts subdivided therefrom shall be used or maintained as a dumping ground for rubbish or trash, and garbage or other waste shall be kept except in sanitary containers.

NINTH: No truck, bus, trailer, or any other motor vehicle shall be left parked in the street in front of the Property, or any tracts subdivided therefrom, except for construction and repair equipment while a residence or residences are being built or repaired in the immediate vicinity. No boat, trailer, camper body or similar vehicle shall be parked for storage in the driveway or front yard of any dwelling, nor shall any such vehicle be parked for storage in the side yard of any dwelling unless parked to the rear of a privacy fence. No vehicle, mobile home, or any other titled and/or licensed vehicle shall be kept on or about the Property, or any tracts subdivided therefrom, unless its title, inspection, license and registration are current.

TENTH: No professional, business, or commercial activity to which the general public is invited shall be conducted on the Property, or any tracts subdivided therefrom.

ELEVENTH: No building or used house or structure of any kind or character whatsoever shall be moved on any tracts subdivided from the Property.

TWELFTH: All construction and the location of any structure or improvement shall comply with all applicable Building Codes and governmental regulations.

THIRTEENTH: No animals (including domestic pets), livestock, reptiles, dog kennels, or poultry of any kind shall be raised, bred, or kept on the Property for commercial purposes. No swine, pigs, or hogs of any kind shall be raised, bred or kept on the Property, or any tracts subdivided therefrom. A maximum of one (1) large animal (cattle or horses) per two (2) acres. Thirty small animals (sheep, rabbits, poultry, 5 barn cats, dogs, etc.) may be raised, bred or kept on the Property, or any tracts subdivided therefrom, at any one time. No corrals, barns, or confinement pens shall be any closer than 125 feet from front of any tract.

FOURTEENTH: No tract may be sub-divided.

# TARRANT COUNTY

WAYNE LERMAN SR FAMILY TRUST  
VOL. 1805, PG. 704  
O. P. R. W. C.

BRYAN M HANFORD  
VOL. 2942, PG. 505  
O. P. R. W. C.

FRED E DWYER  
VOL. 4111, PG. 488  
O. P. R. W. C.

REILLY ROAD

RIFLE RANGE ROAD

WILLIAM RAY SR & ELIZABETH SEFOK  
VOL. 2719, PG. 522  
O. P. R. W. C.

Survey of 13 Tracts of School Land in Tarrant County, Texas, for the purpose of the proposed 14th section of the 14th range, 28th meridian, Tarrant County, Texas. The survey was made by the Tarrant County Surveyor, under the authority of the Tarrant County Board of Commissioners, on the 14th day of March, 2020. The survey was made in accordance with the provisions of the Texas Surveying Act, Chapter 131, Texas Government Code, and the rules and regulations of the Tarrant County Surveyor. The survey was made in accordance with the provisions of the Texas Surveying Act, Chapter 131, Texas Government Code, and the rules and regulations of the Tarrant County Surveyor. The survey was made in accordance with the provisions of the Texas Surveying Act, Chapter 131, Texas Government Code, and the rules and regulations of the Tarrant County Surveyor.

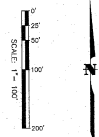

REGISTERED PROFESSIONAL LAND SURVEYOR NO. 5866

**SURVEY OF 13 TRACTS OUT OF SECTION 14 TARRANT COUNTY SCHOOL LAND A-282 WICHITA COUNTY, TEXAS**

CORLETT, PROBST & BOYD, P.L.L.C.  
4605 OLD JACKSONBOE HIGHWAY  
WICHITA FALLS, TEXAS 76798-1202  
TEL: 817-273-1202  
FAX: 817-273-1203  
MARCH, 2020  
SHEET 1 OF 1

BASES OF BEARINGS ARE MAG 83 - TEXAS NORTH CENTRAL

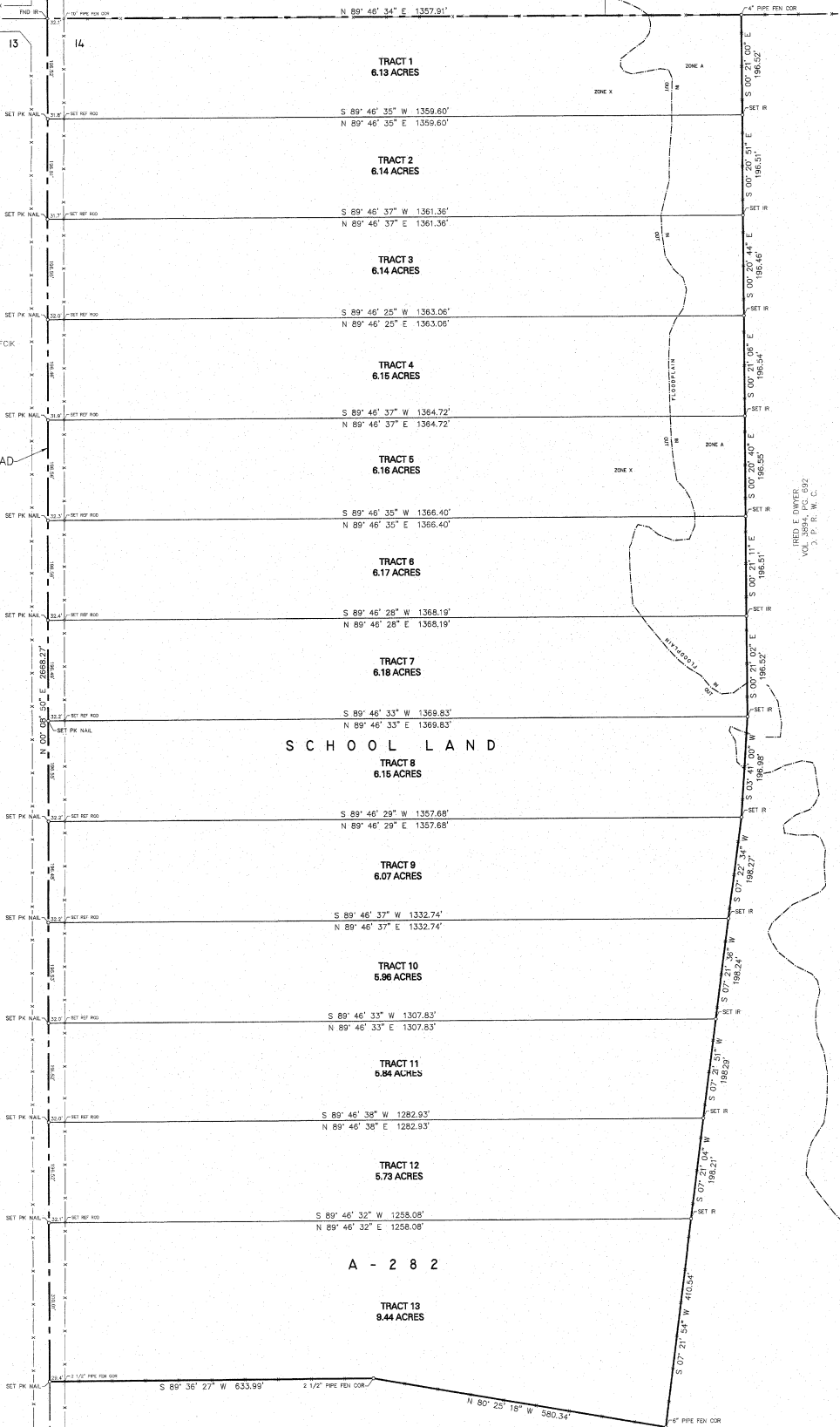

FRED E DWYER  
VOL. 3894, PG. 692  
O. P. R. W. C.

FRED E DWYER  
VOL. 3894, PG. 692  
O. P. R. W. C.

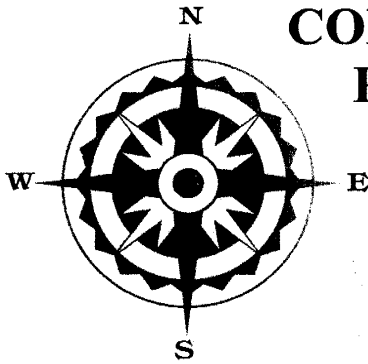

**CORLETT,  
PROBST &  
BOYD, P.L.L.C.**

Texas Registered Engineering Firm F-279  
Texas Licensed Surveying Firm 100541-00

*Principals*

T. Dean Hinton, P.E.  
Devin G. Smith, P.E., R.P.L.S.

TRACT 1  
FIELD NOTES

FIELD NOTES OF A 6.13 ACRE TRACT OF LAND OUT OF SECTION 14, TARRANT COUNTY SCHOOL LAND, WICHITA COUNTY, TEXAS, AND MORE PARTICULARLY DESCRIBED BY METES AND BOUNDS AS FOLLOWS:

BEGINNING at an iron rod found in the center of Rifle Range Road at the Northwest corner of Section 14, Tarrant County School Land, for the Northwest corner of this tract;

THENCE N 89° 46' 34" E with the North line of said Section 14, at 32.1 feet pass a 10" pipe fence corner in the fenced East line of Rifle Range Road and continuing on the same course with a fence line, in all a distance of 1357.91 feet to a 4" pipe fence corner found for the Northeast corner of this tract;

THENCE S 0° 21' 00" E with a fence line a distance of 196.52 feet to an iron rod set for the Southeast corner of this tract;

THENCE S 89° 46' 35" W at 1327.8 feet pass an iron rod set in the fenced East line of Rifle Range Road, and continuing on the same course, in all a distance of 1659.60 feet to a PK nail set in the West line of Section 14, Tarrant County School Land for the Southwest corner of this tract;

THENCE N 00° 08' 50" E with the West line of said Section 14 a distance of 196.5 feet to the PLACE of BEGINNING and containing 6.13 acres of land.

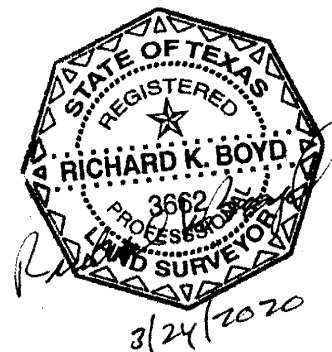

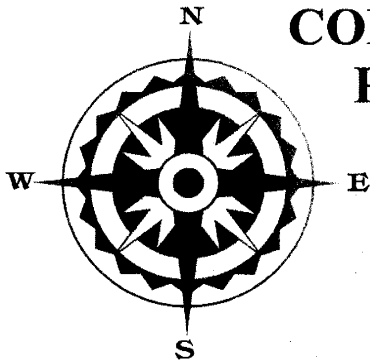

**CORLETT,  
PROBST &  
BOYD, P.L.L.C.**

Texas Registered Engineering Firm F-279  
Texas Licensed Surveying Firm 100541-00

*Principals*

T. Dean Hinton, P.E.  
Devin G. Smith, P.E., R.P.L.S.

TRACT 2  
FIELD NOTES

FIELD NOTES OF A 6.14 ACRE TRACT OF LAND OUT OF SECTION 14, TARRANT COUNTY SCHOOL LAND, WICHITA COUNTY, TEXAS, AND MORE PARTICULARLY DESCRIBED BY METES AND BOUNDS AS FOLLOWS:

BEGINNING at a PK nail set in the West line of said Section 14, 196.52 feet S 00° 08' 50" W of its Northwest corner and being in the center of Rifle Range Road, for the Northwest corner of this tract;

THENCE N 89° 46' 35" E at 31.8 feet pass an iron rod set in the fenced East line of Rifle Range Road, and continuing on the same course, in all a distance of 1359.60 feet to an iron rod set in a fence line for the Northeast corner of this tract;

THENCE S 00° 20' 51" E with a fence line a distance of 196.51 feet to an iron rod set for the Southeast corner of this tract;

THENCE S 89° 46' 37" W at 1329.66 feet pass an iron rod set in the fenced East line of Rifle Range Road and continuing on the same course, in all a distance of 1361.36 feet to a PK nail set in the West line of Section 14, Tarrant County School Land for the Southwest corner of this tract;

THENCE N 00° 08' 50" E with the West line of said Section 14 a distance of 196.51 feet to the PLACE of BEGINNING and containing 6.14 acres of land.

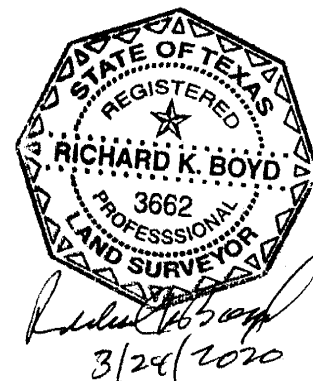

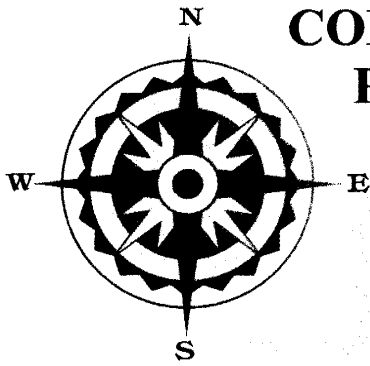

**CORLETT,  
PROBST &  
BOYD, P.L.L.C.**

Texas Registered Engineering Firm F-279  
Texas Licensed Surveying Firm 100541-00

*Principals*

T. Dean Hinton, P.E.  
Devin G. Smith, P.E., R.P.L.S.

TRACT 3  
FIELD NOTES

FIELD NOTES OF A 6.14 ACRE TRACT OF LAND OUT OF SECTION 14, TARRANT COUNTY  
SCHOOL LAND, WICHITA COUNTY, TEXAS, AND MORE PARTICULARLY DESCRIBED BY  
METES AND BOUNDS AS FOLLOWS:

BEGINNING at a PK nail set in the West line of said Section 14, 393.03 feet S 00° 08' 50" W of its  
Northwest corner and being in the center of Rifle Range Road, for the Northwest corner of this tract;

THENCE N 89° 46' 37" E at 31.7' pass an iron rod set in the fenced East line of Rifle Range Road and  
continuing on the same course, in all a distance of 1361.36 feet to an iron rod set in a fence line for the  
Northeast corner of this tract;

THENCE S 00° 20' 44" E with a fence line a distance of 196.46 feet to an iron rod set for the Southeast  
corner of this tract;

THENCE S 89° 46' 25" W at 1331.06 feet pass an iron rod set in the fenced East line of Rifle Range Road  
and continuing on the same course, in all a distance of 1363.06 feet to a PK nail set in the West line of  
Section 14, Tarrant County School Land for the Southwest corner of this tract;

THENCE N 00° 08' 50" E to the West line of said Section 14 a distance of 196.55 feet to the PLACE of  
BEGINNING and containing 6.14 acres of land.

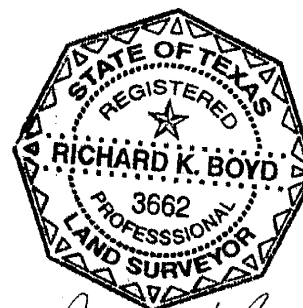

*Richard K. Boyd*  
3/24/2020

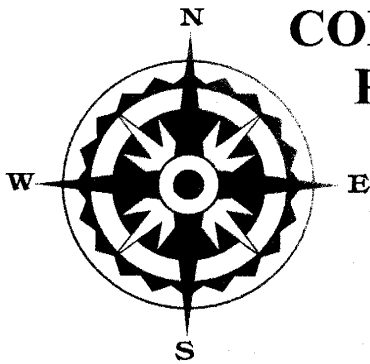

**CORLETT,  
PROBST &  
BOYD, P.L.L.C.**

Texas Registered Engineering Firm F-279  
Texas Licensed Surveying Firm 100541-00

*Principals*

T. Dean Hinton, P.E.  
Devin G. Smith, P.E., R.P.L.S.

TRACT 4  
FIELD NOTES

FIELD NOTES OF A 6.15 ACRE TRACT OF LAND OUT OF SECTION 14, TARRANT COUNTY  
SCHOOL LAND, WICHITA COUNTY, TEXAS, AND MORE PARTICULARLY DESCRIBED BY  
METES AND BOUNDS AS FOLLOWS:

BEGINNING at a PK nail set in the West line of said Section 14, 589.58 feet S 00° 08' 50" W of its  
Northwest corner and being in the center of Rifle Range Road, for the Northwest corner of this tract;

THENCE N 89° 46' 25" E at 32.0 feet pass an iron rod set in the fenced East line of Rifle Range Road and  
continuing at the same course, in all a distance of 1363.06 feet to an iron rod set in a fence line for the  
Northeast corner of this tract;

THENCE S 00° 21' 06" E with a fence line a distance of 196.54 feet to an iron rod set for the Southeast  
corner of this tract;

THENCE S 89° 46' 37" W at 1332.82 feet pass an iron rod set in the fenced East line of Rifle Range Road  
and continuing on the same course, in all a distance of 1364.72 feet to a PK nail set in the West line of  
Section 14, Tarrant County School Land for the Southwest corner of this tract;

THENCE N 00° 08' 50" E with the West line of the said Section 14 a distance of 196.46 feet to the PLACE  
of BEGINNING and containing 6.15 acres of land.

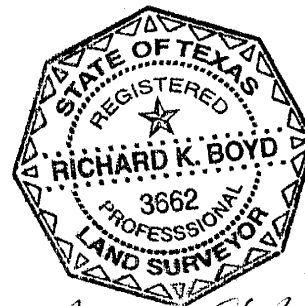

*Richard K. Boyd*  
3/24/2020

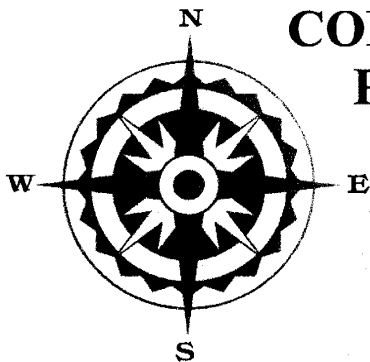

**CORLETT,  
PROBST &  
BOYD, P.L.L.C.**

Texas Registered Engineering Firm F-279  
Texas Licensed Surveying Firm 100541-00

*Principals*

T. Dean Hinton, P.E.  
Devin G. Smith, P.E., R.P.L.S.

TRACT 5  
FIELD NOTES

FIELD NOTES OF A 6.16 ACRE TRACT OF LAND OUT OF SECTION 14, TARRANT COUNTY SCHOOL LAND, WICHITA COUNTY, TEXAS, AND MORE PARTICULARLY DESCRIBED BY METES AND BOUNDS AS FOLLOWS:

BEGINNING at a PK nail in the West line of said Section 14, 786.04 feet S 00° 08' 50" W of its Northwest corner and being in the center of Rifle Range Road for the Northwest corner of this tract;

THENCE N 89° 46' 37" E at 31.9 feet pass an iron rod set in the fenced East line of Rifle Range Road and continuing on the same course, in all a distance of 1364.72 feet to an iron rod set in a fence line for the Northeast corner of this tract;

THENCE S 00° 20' 40" E with a fence line a distance of 196.55 feet to an iron rod set for the Southeast corner of this tract;

THENCE S 89° 46' 35" W at 1334.10 feet pass an iron rod set in the fenced East line of Rifle Range Road and continuing on the same course, in all a distance of 1366.40 feet to a PK nail set in the West line of Section 14, Tarrant County School Land for the Southwest corner of this tract;

THENCE N 00° 08' 50" E with the West line of said Section 14 a distance of 196.56 feet to the PLACE of BEGINNING and containing 6.16 acres of land.

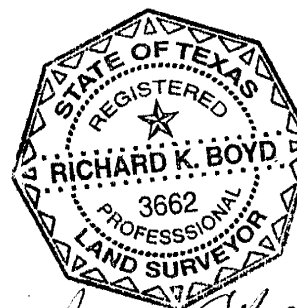

*Richard K. Boyd*  
3/24/2020



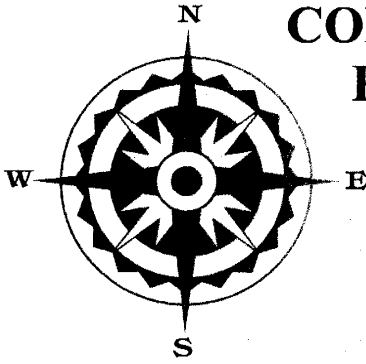

**CORLETT,  
PROBST &  
BOYD, P.L.L.C.**

Texas Registered Engineering Firm F-279  
Texas Licensed Surveying Firm 100541-00

*Principals*

T. Dean Hinton, P.E.  
Devin G. Smith, P.E., R.P.L.S.

TRACT 6  
FIELD NOTES

FIELD NOTES OF A 6.17 ACRE TRACT OF LAND OUT OF SECTION 14, TARRANT COUNTY  
SCHOOL LAND, WICHITA COUNTY, TEXAS, AND MORE PARTICULARLY DESCRIBED BY  
METES AND BOUNDS AS FOLLOWS:

BEGINNING at a PK nail in the West line of said Section 14, 982.60 feet S 00° 08' 50" W of its Northwest corner and being in the center of Rifle Range Road for the Northwest corner of this tract;

THENCE N 89° 46' 35" E at 32.3 feet pass an iron rod set in the fenced East line of Rifle Range Road and continuing on the same course, in all a distance of 1366.40 feet to an iron rod set in a fence line for the Northeast corner of this tract;

THENCE S 00° 21' 11" E with a fence line a distance of 196.51 feet to an iron rod set for the Southeast corner of this tract;

THENCE S 89° 46' 28" W at 1335.79 feet pass an iron rod set in the fenced East line of Rifle Range Road and continuing on the same course, in all a distance of 1368.19 feet to a PK nail set in the West line of Section 14, Tarrant County School Land for the Southwest corner of this tract;

THENCE N 00° 08' 50" E with the West line of said Section 14 a distance of 196.56 feet to the PLACE of BEGINNING and containing 6.17 acres of land.

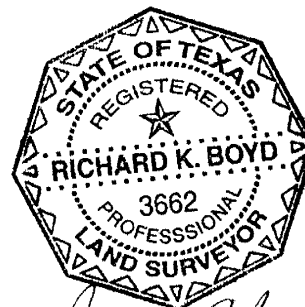

*Richard K. Boyd*  
3/24/2020

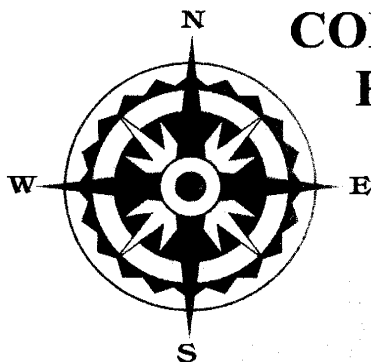

**CORLETT,  
PROBST &  
BOYD, P.L.L.C.**

Texas Registered Engineering Firm F-279  
Texas Licensed Surveying Firm 100541-00

*Principals*

T. Dean Hinton, P.E.  
Devin G. Smith, P.E., R.P.L.S.

TRACT 7  
FIELD NOTES

FIELD NOTES OF A 6.18 ACRE TRACT OF LAND OUT OF SECTION 14, TARRANT COUNTY  
SCHOOL LAND, WICHITA COUNTY, TEXAS, AND MORE PARTICULARLY DESCRIBED BY  
METES AND BOUNDS AS FOLLOWS:

BEGINNING at a PK nail in the West line of said Section 14, 1179.16 feet S 00° 08' 50" W of its Northwest corner and being in the center of Rifle Range Road for the Northwest corner of this tract;

THENCE N 89° 46' 28" E at 32.4 feet pass an iron rod set in the fenced East line of Rifle Range Road and continuing on the same course, in all a distance of 1368.19 feet to an iron rod set in a fence line for the Northeast corner of this tract;

THENCE S 00° 21' 02" E with a fence line a distance of 196.52 feet to an iron rod set for the Southeast corner of this tract;

THENCE S 89° 46' 33" W at 1337.63 feet pass an iron rod set in the fenced East line of Rifle Range Road and continuing on the same course, in all a distance of 1369.83 feet to a PK nail set in the West line of Section 14, Tarrant County School Land for the Southwest corner of this tract;

THENCE N 00° 08' 50" E with the West line of said Section 14 a distance of 196.49 feet to the PLACE of BEGINNING and containing 6.18 acres of land.

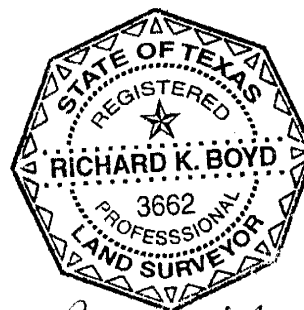

*Richard K. Boyd*  
3/24/2020

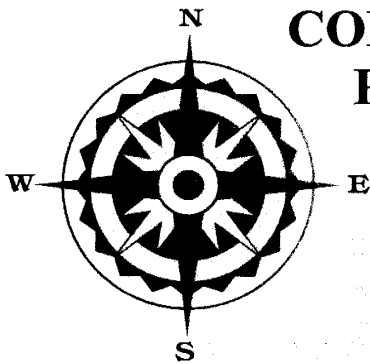

**CORLETT,  
PROBST &  
BOYD, P.L.L.C.**

Texas Registered Engineering Firm F-279  
Texas Licensed Surveying Firm 100541-00

*Principals*

T. Dean Hinton, P.E.  
Devin G. Smith, P.E., R.P.L.S.

TRACT 8  
FIELD NOTES

FIELD NOTES OF A 6.15 ACRE TRACT OF LAND OUT OF SECTION 14, TARRANT COUNTY  
SCHOOL LAND, WICHITA COUNTY, TEXAS, AND MORE PARTICULARLY DESCRIBED BY  
METES AND BOUNDS AS FOLLOWS:

BEGINNING at a PK nail in the West line of said Section 14, 1375.65 feet S 00° 08' 50" W of its Northwest corner and being in the center of Rifle Range Road for the Northwest corner of this tract;

THENCE N 89° 46' 33" E at 32.2 feet pass an iron rod set in the fenced East line of Rifle Range Road and continuing on the same course, in all a distance of 1369.83 feet to an iron rod set in a fence line for the Northeast corner of this tract;

THENCE S 03° 41' 00" W with a fence line a distance of 196.98 feet to an iron rod set for the Southeast corner of this tract;

THENCE S 86° 46' 29" W at 1325.48 feet pass an iron rod set in the fenced East line of Rifle Range Road and continuing on the same course, in all a distance of 1357.68 feet to a PK nail set in the West line of Section 14, Tarrant County School Land for the Southwest corner of this tract;

THENCE N 00° 08' 50" E with the West line of said Section 14 a distance of 196.55 feet to the PLACE of BEGINNING and containing 6.15 acres of land.

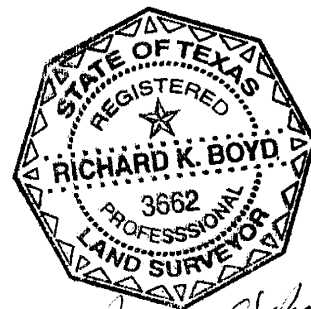

*Richard K. Boyd*  
3/24/2020

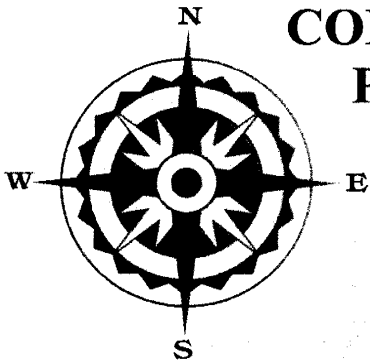

**CORLETT,  
PROBST &  
BOYD, P.L.L.C.**

Texas Registered Engineering Firm F-279  
Texas Licensed Surveying Firm 100541-00

*Principals*

T. Dean Hinton, P.E.  
Devin G. Smith, P.E., R.P.L.S.

TRACT 9  
FIELD NOTES

FIELD NOTES OF A 6.07 ACRE TRACT OF LAND OUT OF SECTION 14, TARRANT COUNTY SCHOOL LAND, WICHITA COUNTY, TEXAS, AND MORE PARTICULARLY DESCRIBED BY METES AND BOUNDS AS FOLLOWS:

BEGINNING at a PK nail in the West line of said Section 14, 1572.20 feet S 00° 08' 50" W of its Northwest corner and being in the center of Rifle Range Road for the Northwest corner of this tract;

THENCE N 89° 46' 29" E at 32.2 feet pass an iron rod set in the fenced East line of Rifle Range Road and continuing on the same course, in all a distance of 1357.68 feet to an iron rod set in a fence line for the Northeast corner of this tract;

THENCE S 07° 22' 34" W with a fence line a distance of 198.27 feet to an iron rod set for the Southeast corner of this tract;

THENCE S 89° 46' 32" W at 1300.54 feet pass an iron rod set in the fenced East line of Rifle Range Road and continuing on the same course, in all a distance of 1332.74 feet to a PK nail set in the West line of Section 14, Tarrant County School Land for the Southwest corner of this tract;

THENCE N 00° 08' 50" E with the West line of said Section 14 a distance of 196.48 feet to the PLACE of BEGINNING and containing 6.07 acres of land.

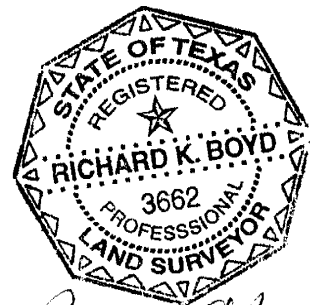

*Richard K. Boyd*  
3/2/2020

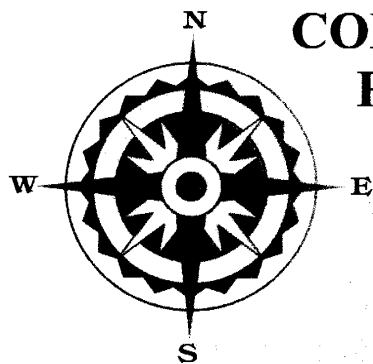

**CORLETT,  
PROBST &  
BOYD, P.L.L.C.**

Texas Registered Engineering Firm F-279  
Texas Licensed Surveying Firm 100541-00

*Principals*

T. Dean Hinton, P.E.  
Devin G. Smith, P.E., R.P.L.S.

TRACT 10  
FIELD NOTES

FIELD NOTES OF A 5.96 ACRE TRACT OF LAND OUT OF SECTION 14, TARRANT COUNTY  
SCHOOL LAND, WICHITA COUNTY, TEXAS, AND MORE PARTICULARLY DESCRIBED BY  
METES AND BOUNDS AS FOLLOWS:

BEGINNING at a PK nail in the West line of said Section 14, 1768.66 feet S 00° 08' 50" W of its Northwest corner and being in the center of Rifle Range Road for the Northwest corner of this tract;

THENCE N 89° 46' 37" E at 32.2 feet pass an iron rod set in the fenced East line of Rifle Range Road and continuing on the same course, in all a distance of 1332.74 feet to an iron rod set in a fence line for the Northeast corner of this tract;

THENCE S 07° 21' 36" W with a fence line a distance of 198.24 feet to an iron rod set for the Southeast corner of this tract;

THENCE S 89° 46' 33" W at 1275.83 feet pass an iron rod set in the fenced East line of Rifle Range Road and continuing on the same course, in all a distance of 1307.83 feet to a PK nail set in the West line of Section 14, Tarrant County School Land for the Southwest corner of this tract;

THENCE N 00° 08' 50" E with the West line of said Section 14 a distance of 196.53 feet to the PLACE of BEGINNING and containing 5.96 acres of land.

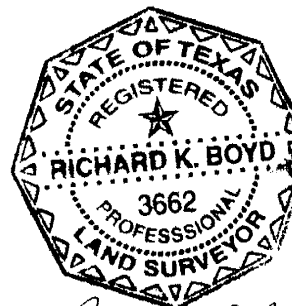

*Richard K. Boyd*  
3/24/2020

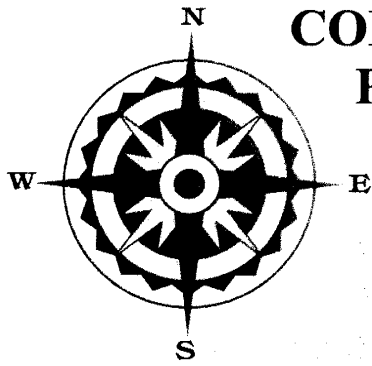

**CORLETT,  
PROBST &  
BOYD, P.L.L.C.**

Texas Registered Engineering Firm F-279  
Texas Licensed Surveying Firm 100541-00

*Principals*

T. Dean Hinton, P.E.  
Devin G. Smith, P.E., R.P.L.S.

TRACT 11  
FIELD NOTES

FIELD NOTES OF A 5.84 ACRE TRACT OF LAND OUT OF SECTION 14, TARRANT COUNTY  
SCHOOL LAND, WICHITA COUNTY, TEXAS, AND MORE PARTICULARLY DESCRIBED BY  
METES AND BOUNDS AS FOLLOWS:

BEGINNING at a PK nail in the West line of said Section 14, 1965.19 feet S 00° 08' 50" W of its Northwest corner and being in the center of Rifle Range Road for the Northwest corner of this tract;

THENCE N 89° 46' 37" E at 32.0 feet pass an iron rod set in the fenced East line of Rifle Range Road and continuing on the same course, in all a distance of 1307.83 feet to an iron rod set in a fence line for the Northwest corner of this tract;

THENCE S 07° 21' 51" W with a fence line a distance of 198.29 feet to an iron rod set for the Southeast corner of this tract;

THENCE S 89° 46' 38" W at 1250.93 feet pass an iron rod set in the fenced East line of Rifle Range Road and continuing on the same course, in all a distance of 1282.93 feet to a PK nail set in the West line of Section 14, Tarrant County School Land for the Southwest corner of this tract;

THENCE N 00° 08' 50" E with the West line of said Section 14 a distance of 196.52 feet to the PLACE of BEGINNING and containing 5.84 acres of land.

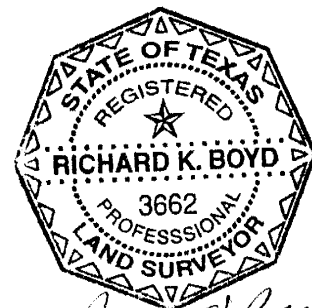

*Richard K. Boyd*  
3/24/2020

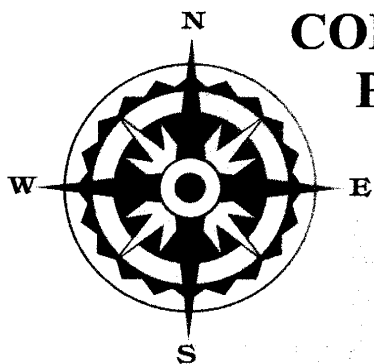

**CORLETT,  
PROBST &  
BOYD, P.L.L.C.**

Texas Registered Engineering Firm F-279  
Texas Licensed Surveying Firm 100641-00

*Principals*

T. Dean Hinton, P.E.  
Devin G. Smith, P.E., R.P.L.S.

TRACT 12  
FIELD NOTES

FIELD NOTES OF A 5.73 ACRE TRACT OF LAND OUT OF SECTION 14, TARRANT COUNTY  
SCHOOL LAND, WICHITA COUNTY, TEXAS, AND MORE PARTICULARLY DESCRIBED BY  
METES AND BOUNDS AS FOLLOWS:

BEGINNING at a PK nail in the West line of said Section 14, 2161.71 feet S 00° 08' 50" W of its Northwest corner and being in the center of Rifle Range Road for the Northwest corner of this tract;

THENCE N 89° 46' 38" E at 32.0 feet pass an iron rod set in the fenced East line of Rifle Range Road and continuing on the same course, in all a distance of 1282.93 feet to an iron rod set in a fence line for the Northwest corner of this tract;

THENCE S 07° 21' 04" W with a fence line a distance of 198.21 feet to an iron rod set for the Southeast corner of this tract;

THENCE S 89° 46' 32" W at 1225.98 feet pass an iron rod set in the fenced East line of Rifle Range Road and continuing on the same course, in all a distance of 1258.08 feet to a PK nail set in the West line of Section 14, Tarrant County School Land for the Southwest corner of this tract;

THENCE N 00° 08' 50" E with the West line of said Section 14 a distance of 196.52 feet to the PLACE of BEGINNING and containing 5.73 acres of land.

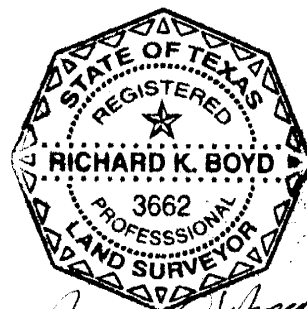

*Richard K. Boyd*  
3/24/2020

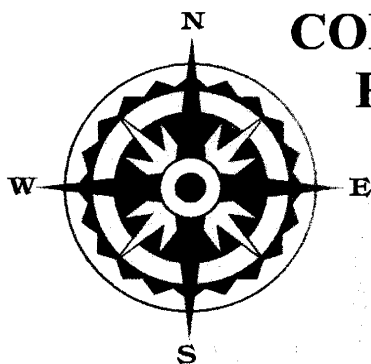

**CORLETT,  
PROBST &  
BOYD, P.L.L.C.**

Texas Registered Engineering Firm F-279  
Texas Licensed Surveying Firm 100541-00

*Principals*

T. Dean Hinton, P.E.  
Devin G. Smith, P.E., R.P.L.S.

TRACT 13  
FIELD NOTES

FIELD NOTES OF A 9.44 ACRE TRACT OF LAND OUT OF SECTION 14, TARRANT COUNTY SCHOOL LAND, WICHITA COUNTY, TEXAS, AND MORE PARTICULARLY DESCRIBED BY METES AND BOUNDS AS FOLLOWS:

BEGINNING at a PK nail in the West line of said Section 14, 2358.23 feet S 00° 08' 50" W of its Northwest corner and being in the center of Rifle Range Road for the Northwest corner of this tract;

THENCE N 89° 46' 32" E at 32.1 feet pass an iron rod set in the fenced East line of Rifle Range Road and continuing on the same course, in all a distance of 1258.08 feet to an iron rod set in a fence line for the Northeast corner of this tract;

THENCE S 07° 21' 54" W with a fence line a distance of 410.54 feet to a 6" pipe fence corner found for the Southeast corner of this tract;

THENCE N 80° 25' 18" W with a fence line a distance of 580.34 feet to 2 2 1/2" pipe fence corner for an angle point;

THENCE S 89° 36' 27" W with a fence line at 604.59 feet pass a 2 1/2" pipe fence corner in the fenced East line of Rifle Range Road, and continuing on the same course, in all a distance of 633.99 to a PK nail in the West line of Section 14, Tarrant County School Land for the Southwest corner of this tract;

THENCE N 00° 08' 50" E with the West line of said Section 14 a distance of 310.01 feet to the PLACE of BEGINNING and containing 9.44 acres of land.

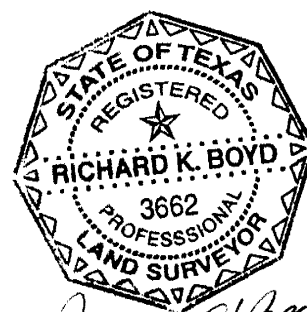

*Richard K. Boyd*  
3/24/2020