

31 Acres | Providence Road | T-10 | Iron Bridge  
Ranchettes  
Red Hill Road  
Calvert, TX 77837

**\$419,270**  
31.05± Acres  
Robertson County



**MORE INFO ONLINE:**  
[www.homelandprop.com](http://www.homelandprop.com)



**31 Acres | Providence Road | T-10 | Iron Bridge Ranchettes**  
**Calvert, TX / Robertson County**

---

**SUMMARY**

**Address**

Red Hill Road

**City, State Zip**

Calvert, TX 77837

**County**

Robertson County

**Type**

Recreational Land, Farms

**Latitude / Longitude**

30.926413 / -96.649965

**Acreage**

31.05

**Price**

\$419,270

**Property Website**

<https://homelandprop.com/property/31-acres-providence-road-t-10-iron-bridge-ranchettes/robertson/texas/95504/>

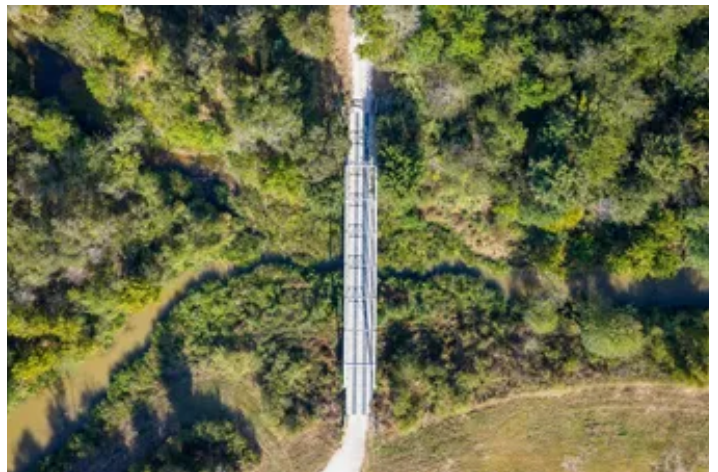

**MORE INFO ONLINE:**

[www.homelandprop.com](http://www.homelandprop.com)

### **PROPERTY DESCRIPTION**

The Iron Bridge Ranchettes, nestled in Robertson County near Bryan/College Station and conveniently close to Highway 6 on the way to Waco, offer 13 carefully curated tracts from about 10.4 to just over 31 acres. With well-maintained county road access and approximately 90 feet of elevation change across the property, access is a breeze, and the views are stunning. Tracts 1 to 3 are fully wooded with trails; tracts 4 to 7 are open pasture; tracts 8 to 9 balance woods and pasture, while tracts 10 to 13 feature open pasture along the live water 'Mud Creek' and the intersection of the Little Brazos River. Tract 5 highlights a 2019 barndominium (approx. 2,200 sq. ft.) with a new garage/shop and a pond. Each tract offers scenic terrain, utilities, ag exemptions, and endless potential—perfect for ranching, recreation, or your future homesite. With the diversity of this offering, there is sure to be something for everyone. Close enough to town, but far enough to see the stars. Come take a look! Seller believes to own 25% of oil/gas minerals which will convey with sale - buyer to independently verify.

---

**Utilities:** Electric available, Water available or well

**Utility Providers:** Navasota Valley Electric, Robertson County WSC



**MORE INFO ONLINE:**

[www.homelandprop.com](http://www.homelandprop.com)



31 Acres | Providence Road | T-10 | Iron Bridge Ranchettes  
Calvert, TX / Robertson County

---



**MORE INFO ONLINE:**  
[www.homelandprop.com](http://www.homelandprop.com)

## Locator Map

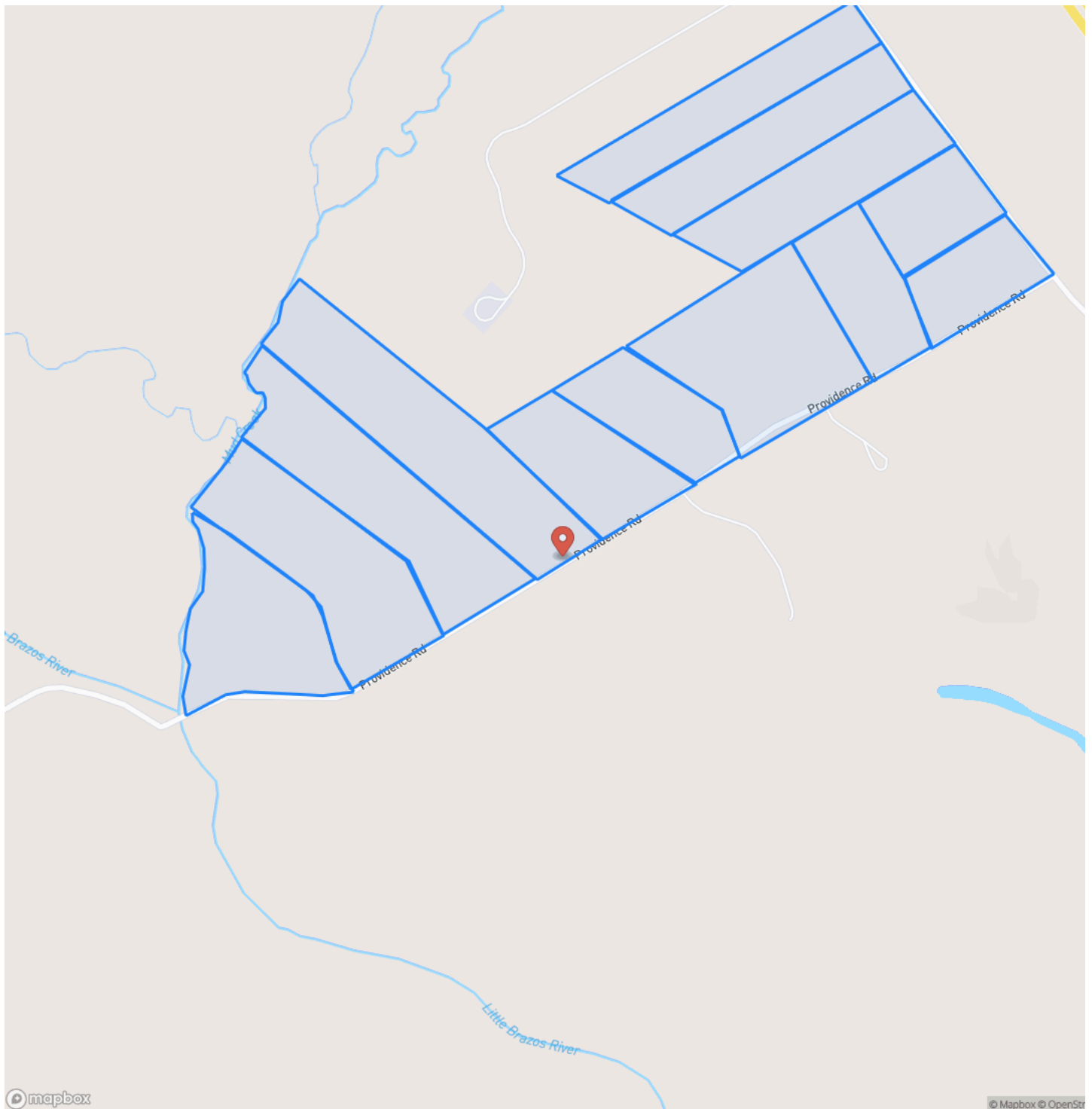



## Calvert, TX / Robertson County

## Locator Map

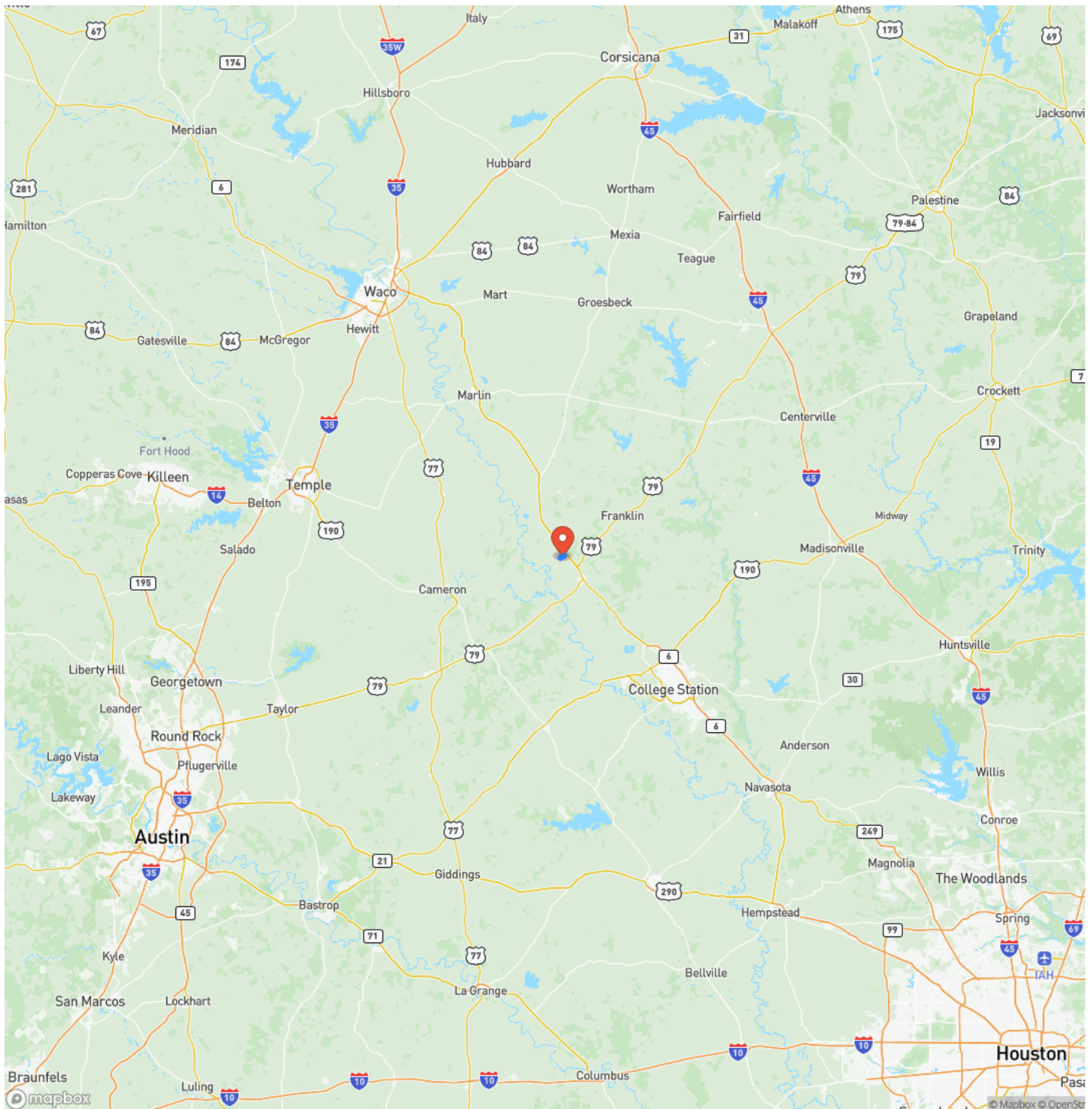

**MORE INFO ONLINE:**

**www.homelandprop.com**

## Satellite Map





**31 Acres | Providence Road | T-10 | Iron Bridge Ranchettes**  
**Calvert, TX / Robertson County**

## LISTING REPRESENTATIVE

**For more information contact:**



### Representative

Walker Powell

## Mobile

(936) 661-9442

## Office

(936) 295-2500

## Email

walker@homelandprop.com

**Address**

1600 Normal Park Dr

## City / State / Zip

Huntsville, TX 77340

## NOTES



**MORE INFO ONLINE:**

**www.homelandprop.com**



[illegible]

## **DISCLAIMERS**

**Property Listing Disclaimer:** The use and/or reproduction of any marketing materials generated by Homeland Properties, Inc. ("HomeLand") and/or its associated clients, including but not limited to maps, videos, photos, spreadsheets, diagrams, contracts, documents, etc. is strictly prohibited without HomeLand's written consent. The information contained herein are obtained from sources either accepted to be reliable or provided to HomeLand by the Seller. HomeLand makes no affirmative guarantee as to their accuracy. This listing is subject to change in price, errors, omissions, prior sales, or withdrawal without notice. Furthermore, this disclaimer shall supersede any & all information published by any MLS site, whether by permission or not, including any and all information relating to co-broker fees.

**Mineral Rights and Natural Resources Disclaimer:** HomeLand Properties, Inc provides no warranties as to the status of title of any Mineral Rights and other Natural Resources of the Property. Seller may require Seller's own Purchase and Sale Agreement ("PSA") to be used that may expressly reserve or except the Mineral Rights and other Natural Resources on the Property from the purchase. Oil and gas minerals have been reserved by prior owners.

**Acreage, Survey & Easement Disclaimer:** HomeLand Properties, Inc. provides no warranties as to the size area or quantity of acres of the Property in this listing. Any representations shown in this listing of number of acres, dimensions of the Property, or shape of the Property, should be considered approximate and are not guaranteed accurate. For any property being divided out of a larger tract of land, a survey shall be required to be purchased, subject to negotiation between Seller and Buyer. Seller reserves the right to require the use of Seller's preferred surveyor. Easements may exist on the Property that are not currently visible and apparent and/or marked in the field. The approximate front corners are marked with red/yellow tape.

**Title Insurance Company Disclaimer:** Seller reserves the right to require the use of Seller's preferred Title Insurance Company.

**Tax Disclaimer:** Approximately \$5/Acre/Year with Ag Exemption. Homeland Properties, Inc. provides no warranties as to the Central Appraisal Districts ("CAD") appraisal designation of the Property, market and tax values of the Property, status of any existing tax exemptions of the Property, or qualification of any exemptions based upon Buyer's future usage of the Property. Property may be subject to roll back taxes. Payment of any future rollback taxes shall be subject to negotiation between Buyer and Seller, at the time of contract. Current taxes for the Property may or may not be available due to subject Property being part of a larger overall tract, and not yet assigned a Tax Identification number by the CAD.

**Legal Description Disclaimer:** Size is approximate and subject to recorded legal description or surveyed gross acres to include, but not limited to, any acres lying within roads and/or easements. CAD shape files are not reliable. Shape files per maps herein are considered the most accurate available and are derived using the best information available, included, but not limited to, GIS data, field data, legal descriptions, and survey, if available.

**Easement Disclaimer:** Visible and apparent and/or marked in field. Pipelines on or directly adjoining Tracts 7-9.



**MORE INFO ONLINE:**

**[www.homelandprop.com](http://www.homelandprop.com)**



---

**HomeLand Properties, Inc.**  
1600 Normal Park Dr.  
Huntsville, TX 77340  
(936) 295-2500  
[www.homelandprop.com](http://www.homelandprop.com)

---



**MORE INFO ONLINE:**  
[www.homelandprop.com](http://www.homelandprop.com)