

Basic Information	
Parcel Number:	0000-25-10N-06W-4-001-00
County Name:	Grady County
Property Address:	JACKSON, LAJUENE REV. LIV TRST JACKSON, LAJUENE & OTIS AS TRUSTEES 1603 TYLER TUTTLE, OK
Mailing Address:	JACKSON, LAJUENE REV. LIV TRST JACKSON, LAJUENE & OTIS AS TRUSTEES 1583 COUNTY ROAD 1200 TUTTLE OK 73089-0000
Total Acres:	11.42
Timber Acres:	0.00
Sec-Twp-Rng:	25-10N-06W
Lot/Block:	/
Subdivision:	
Legal Description:	25-10-06-00800 SE/4 & NE/4 SW/4 & E/2 SE/4 SW/4 LESS TR BEG 326 E OF SW/C SE/4 TH N 231 E 190' S 231' W 190' TO BEG (1 AC) LESS A TR BEG AT SW/C SE/4 SE/4 SW/4 SAID POINT BEING 1989.31' E OF SW/C OF SAID SEC. 25 TH N 00 00'15"E 275', N 89 54'16"E 316.8', S 00 00'15"W 275', S 89 54'16" W 316.80' TO POB. (CONT. 2 AC.)
School District:	9097 TUTTLE CTY 97 TUTTLE
Homestead Parcel?:	Yes
Tax Status:	Taxable
Over 65?:	No

Land Information						
Land Type	Quantity	Front Width	Rear Width	Depth 1	Depth 2	Quarter
HM01	1.00 acres [43,560 sqft]					
IP	10.42 acres [453,895 sqft]					

Valuation Information			
Entry	Appraised / Fair Cash Value	Assessed	
Land:	4,755	523	
Improvements:	133,100	14,641	
Total Value:	137,855	15,164	
Taxable Value:		15,164	
Homestead Discount:		-1,000	
Disabled Elligible?:		No	
Net Assessed:		14,164	
Assessment Level:		0.11	
Millage:		0.1136	
Estimated Taxes:		\$1,609.00	
Assessment Year:		2024	

Sales History ⓘ

 No sales history available

×

Improvement Information
Residential Improvements
Residential Improvement #1

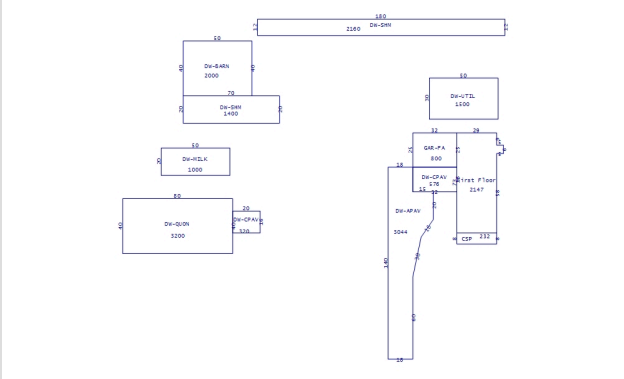

Total Square Foot:	2,147
Occupancy Type:	Single Family
Quality:	Average
Style :	1 Story
Year Built:	1930
Effective Age:	56
Bathrooms:	1.5